



SGI 200

Sarvesh Analytics brings the most reliable Sampling Gas Cooler with Integrated Autodrain, Filter and Condensate Sensor in a most compact form. It simplifies the sample condition design and manufacturing.

Complete Sampling System

- Compact System
- Solid Heat Exchanger
- Dual Channel Cooler with High Discharge Peristaltic Pump
- Sample Filter with Condensate Sensor
- Output for External Sample Pump

Optional

- PTFE Heat Exchanger

Salient Features

- PLUG and PLAY
- Microprocessor based Electronics
- Sample Pump output is ON only when
 - Sample temperature $<12^{\circ}\text{C}$
 - Sample is dry without Condensate

Specifications

Sample Filter	0.1 Micron GMF, Coalescing
Condensate Sensor	Gold Plated Conductivity Sensor
Sample Connection	Inlet / Outlet / Drain - 1/4" OD
Wetted Parts	SS 316, PTFE, Silicon, Plastic

Cooler Specifications	
Heat Exchangers	2 x SS316 / PTFE coils
Sample Inlet Temperature	Max 140 ° C
Maximum Sample Dewpoint	65 ° C
Maximum Sample Flow	240 LPH (4 LPM)
Sample Outlet Temperature	5 ° C
Autodrain	2 x Peristaltic Pump

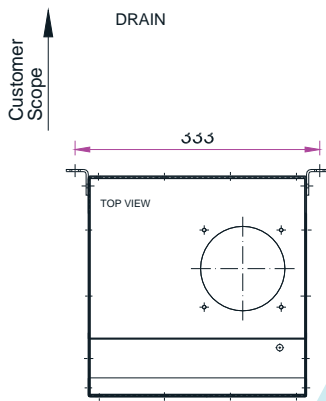
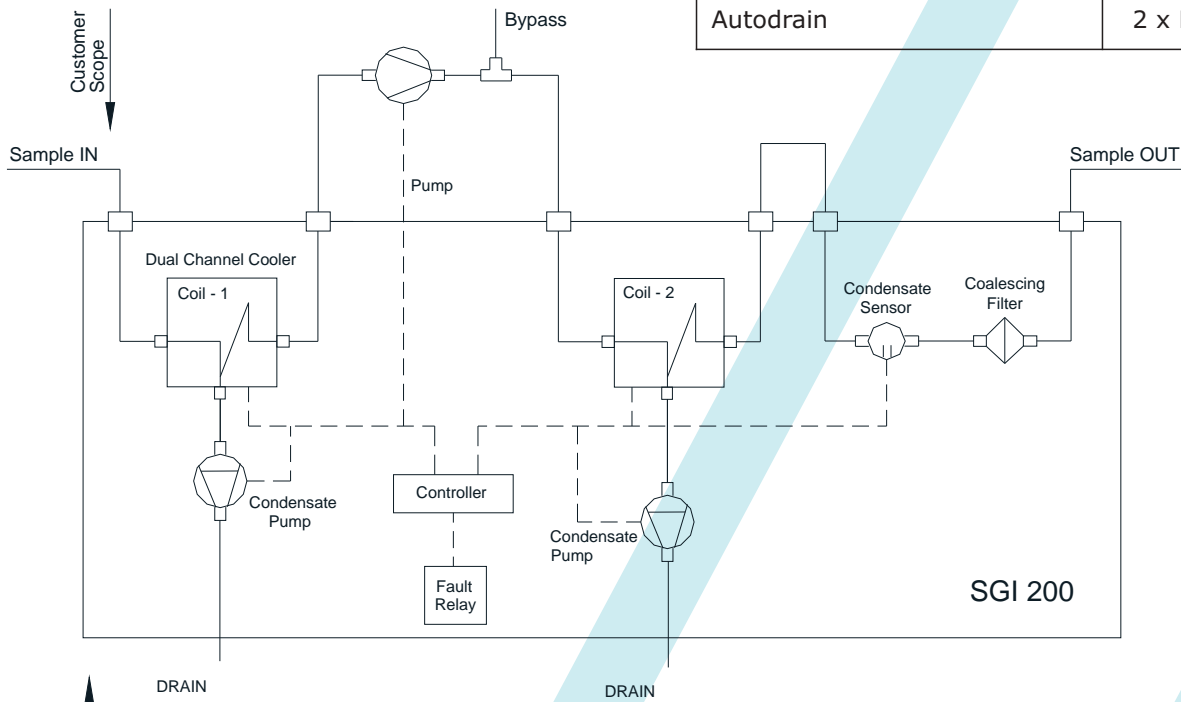

Controls	Microprocessor Based Electronics
Fault Alarm	Potential Free Relay rated @ 230V ac 50 Hz, 1A
Power Supply	230 V AC, 50 Hz, 350 VA excluding Sample Pump

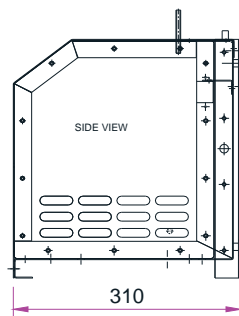
Notes:

- The final responsibility to check whether this product meets the requirement of the Process and / or Analyser remains solely with the customer.
- We have a policy of constant product improvement and therefore reserves the right to change specifications without prior notice.